

Using your Slimline Touchpad

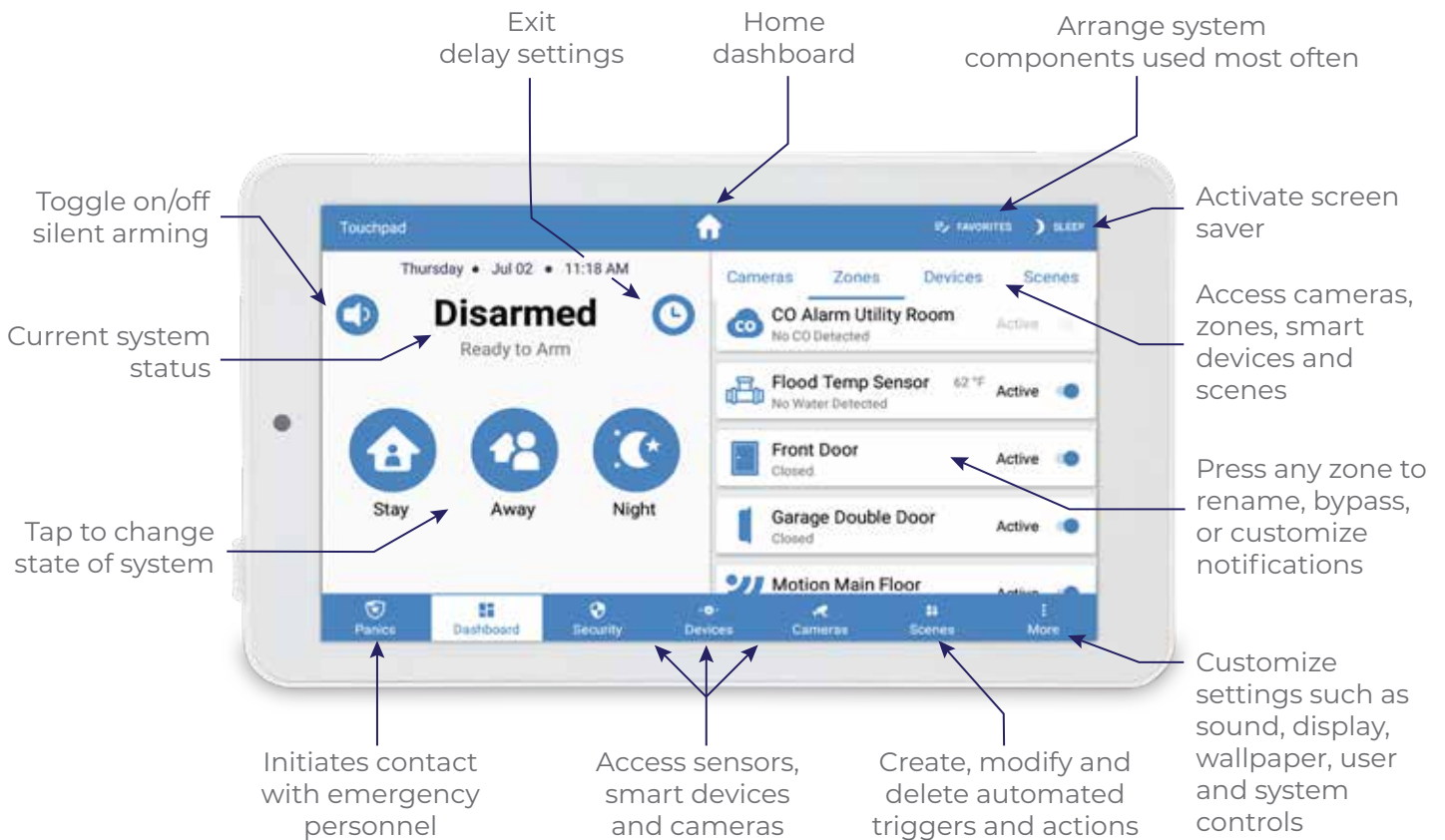

The 7" Touchscreen on your Alula Smart Security System is the central hub for keeping tabs on everything that happens with your system. Arm, disarm and check sensor status. View live and recorded video and interact with visitors at the front door. Control smart lights and all your other Z-Wave smart devices. Plus, the controls are the same as the mobile app so you can rest assured that using your Touchpad will be simple, easy and fit in with your busy schedule.



See reverse side for arming functions →

Arming Functions



Select the **STAY** icon to arm your system while you are still at home. Motion detectors will be disabled.



Set your security system to **AWAY** when you plan to leave. This setting keeps all motion detectors active.

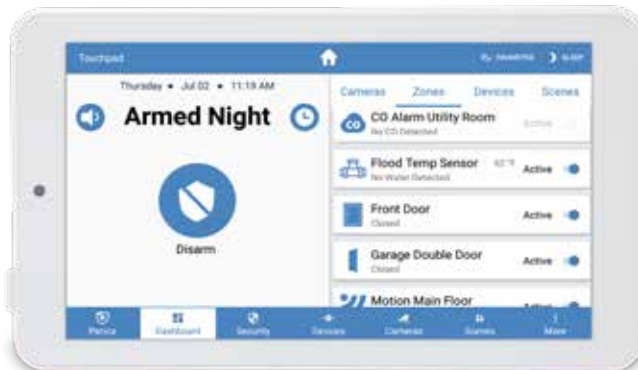

Use **ARMED NIGHT** when you are on premises overnight. Your system will arm immediately without an exit delay, motion detectors can be either active or inactive based on preference.



When setting your system to **STAY** or **AWAY**, the system status will show **ARMING** and an **EXIT DELAY** countdown will start. This gives you time to leave the premise before the system is activated.

Contact your Alula security dealer with questions
or to add a touchpad to your system